



SAFETY COVER Installation & Maintenance Manual

BEFORE YOU START:

Thank you for your purchase of a WaterWarden Pool Safety Cover. Please read these instructions in their entirety prior to installation to ensure a smooth and proper installation. Retain manual for future reference.

POOL SITE:

1. Examine the deck area immediately around the pool. There must be a minimum of 3' (feet) of deck space around the pool on all sides for proper installation. (The cover itself will overlap the pool from water's edge approximately 9"-18" onto the deck surface. The springs and straps will extend an additional 17" from cover's edge.)

2. Examine the deck surface. Ensure that there are no impediments or obstacles on the deck surface which would prevent the cover from lying flat. Identify any rough coping, ladder sockets, waterspouts, or other items that are not flush with the deck. These surfaces should be padded with carpet, foam or vinyl to help protect the cover from chafing and excessive wear and tear.

LIST OF TOOLS NEEDED FOR INSTALLATION:

- Rotary hammer drill
- 3/4" concrete drill bit w/long shaft (diamond tip)
- Lubricant (silicone spray)
- Hammer
- Tape measure
- Chalk and chalk line

INCLUDED HARDWARE:

Ensure that the following hardware has been included with your safety cover. If you determine that you are missing any of these components, please call WaterWarden Pool Safety Products toll free 609-212-0221 for immediate resolution.

- Brass anchors
- Stainless steel springs
- Steel installation rod
- Hex key
- Spring covers
- Tamping tool

INSTALLING YOUR SAFETY COVER:

1. Prior to beginning, leave the water level in the pool at normal height. This will allow cover to float during the installation and make the installation easier. Remove the safety cover from the box and carefully unfold it. Ensure that the cover is right-side-up and that protective strips are on bottom (pool side). Drape the cover over the pool and stretch cover evenly over the pool as tightly as possible. Adjust the cover so that overlap is equal on all sides. Use water bags or 5-gallon buckets placed on the straps to secure the cover in place. Thread the straps through the D-ring springs, leaving about 6"-7" of strap between the cover's edge and the spring. This is to allow for adjustment.



2. Find the center strap along the length of each side of the cover. Use a piece of chalk to mark a point 3" beyond the uncompressed spring (or about 18" from the cover's edge). These will be the spots for your initial anchor holes. Repeat for the center strap along the width of the cover. Use the marked spot as a guide on each side, and snap a chalk line along the entire length of the pool. This will ensure that the anchors will be installed parallel to the pool.

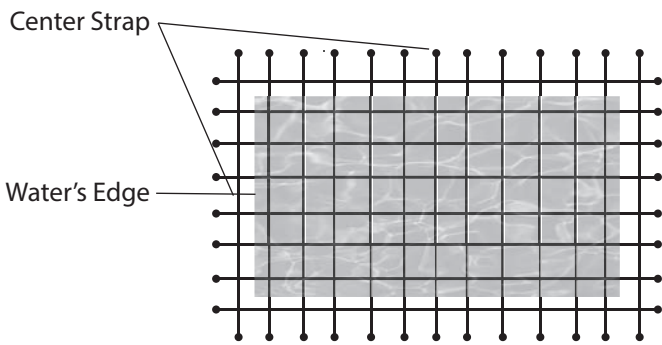

3. Now you will install the first four anchors – the center anchor on each of the 4 sides of the pool. Use the hammer drill and a 3/4” drill bit and be sure to keep the drill perpendicular to the deck surface. Drill down 1^{7/8}” into deck at the center mark on one side of the pool. Remove drilling dust from the anchor hole. Remove anchor screw from its casing and spray casing and tamping tool with silicone. Insert tamping tool in casing and tamp anchor in place.

4. Use the supplied installation rod to attach a spring to the anchor. Slip the notched end of the rod through the round section of the spring. Place the notch over the anchor and use leverage to pull the installation rod away from the pool, so that the spring slides down the rod and the round section of the spring slides over the anchor.

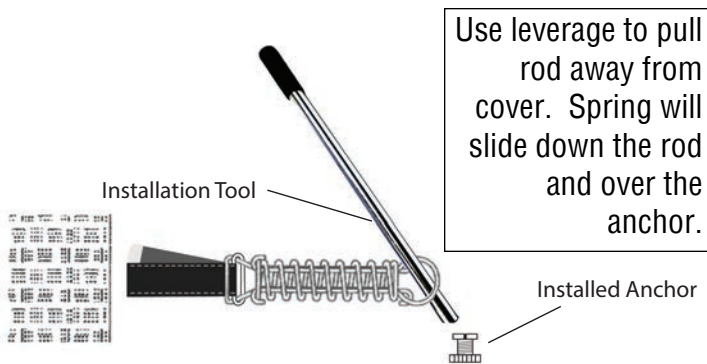

5. Proceed to the opposite side of the pool. Drill and install the anchor for the opposite end of the same strap. Attach the spring to the anchor using the method above. Repeat for the center anchor on the two remaining sides of the pool.

6. After the center straps are secured along both the length and width of the pool, install those straps closest to the center along the length and then those nearest to the center along the width. Grab a strap, stretch it straight and tight to the 18” chalk line. Mark the spot for the anchor and drill. Keep going until all straps are secured.

CARE & MAINTENANCE:

- The pool’s water level must never fall below 18” from the main deck level. A low water level may cause cover and/or spring damage during periods of snow accumulation. This damage will not be covered under the warranty.
- Do not walk on the cover except in an emergency situation. Walking or jumping on the cover may result in damage to the cover not covered by the warranty.
- Abrasion strips are sewn to the cover to protect against normal coping wear. The cover should be kept very tight to help lessen the chance of excessive wear not covered under the warranty.
- It is the responsibility of the installer to add protective padding to sharp corners or very rough areas of the pool. Vinyl padding or carpet remnants may be used for such protection.
- The cover should be folded and stored in the supplied storage bag when not in use. Leaves and debris should be removed.
- Ideally, covers should be hosed down prior to storing.
- The cover should be stored in an area free of rodents.
- Check the cover periodically to be sure the cover is secured very tight on the pool. Adjust the straps to achieve the proper tension.
- Do not drag the cover on decking or coping. Tears resulting from mishandling will not be covered under the warranty.
- Do not operate a barbeque in close proximity to the cover as sparks or hot ash may settle on the cover and result in small burn holes, which are not covered under the warranty.

NOTICE:

This cover has been determined to be free of any manufacturing or material defects prior to shipping. Do not drag cover on concrete deck or any abrasive surfaces. Check pool to assure that water level is not lower than 18” below the top of the pool coping. Be careful not to catch springs on cover material. Carefully inspect the cover every year at the time of installation to assure that material has not deteriorated from normal use. It is recommended that rough surfaces be protected with padding (such as carpeting, vinyl, etc.) Any cover needing repair must be returned no later than July 1st for repair no later than September 30th.

WaterWarden Pool Safety Products will NOT be held responsible for improperly installed covers. We recommend your safety cover be installed by a trained professional.



WARNING! AVOID DROWNING RISK!

1. OBJECTS CANNOT BE SEEN UNDER COVER.
2. STAY OFF THE COVER.
3. REMOVE THE COVER COMPLETELY BEFORE SWIMMING.
4. THERE IS NO SUBSTITUTE FOR COMPETENT ADULT SUPERVISION AROUND A SWIMMING POOL.
5. THE WATERWARDEN POOL SAFETY COVER IS NOT DESIGNED TO BE A SUBSTITUTE FOR ADULT SUPERVISION, NOR IS IT A GUARANTEE AGAINST ACCESS TO THE POOL.

ADDITIONAL PRODUCTS YOU MAY BE INTERESTED IN

Mesh Pool Fence



Pool Safety Net



Winter Block® Leaf Nets



SPQ Brands Safety Cover *Limited Warranty*

FIFTEEN YEAR STANDARD MESH AND SOLID COVER WARRANTY

Fifteen year limited warranty from date of purchase with one year full.

From years 2-9, the claimant shall receive a discount of 50% off the list price of a replacement cover at the date of the claim.

From years 10-15, the claimant shall receive a discount of 25% off the list price of a replacement cover at the date of the claim.

TWENTY YEAR PREMIUM MESH AND SOLID COVER WARRANTY

Twenty year limited warranty from date of purchase with one year full.

From years 2-6, the claimant shall receive a discount of 75% off the list price of a replacement cover at the date of the claim.

From years 7-12, the claimant shall receive a discount of 50% off the list price of a replacement cover at the date of the claim.

From years 13-20, the claimant shall receive a discount of 25% off the list price of a replacement cover at the date of the claim.

**ALL WARRANTY CLAIMS MUST BE HANDLED DIRECTLY
WITH SPQ BRANDS. DO NOT RETURN TO YOUR DEALER.
SPQ BRANDS ACCEPTS CLAIMS FROM POOL OWNERS ONLY.**

SPQ Brands warrants to the original purchaser of the Safety Cover that the company will, at its option, repair or replace any safety cover that proves to be defective in either workmanship or material upon prepaid return of the cover by the owner to SPQ Brands, subject to the provisions of the limited warranty stated above, and the exclusions and limitations set forth below. SPQ Brands will, pursuant to the terms of this warranty, at its sole option, either repair the cover at a nominal charge to the owner, or replace the cover per the pro-rated provisions stated herein. All repaired or replaced covers will be returned at the homeowner's expense. The pro-rated basis for cover replacement is set forth above. Warranty valid only within the continental US and Canada.

What is covered: The safety cover is warranted to be free of defects in material and workmanship when leaving the factory.

What is not covered: Any damage due to improper installation, sizing or storage; damage, defects, malfunctions, or other failures arising from use of the product which does not comply with the instructions provided by the manufacturer; excessive wear - water levels must not fall below 18" from the top of the pool, the minimum level required to support snow loads and reduce the chance of cover wear or warping of the hardware, misuse (not being drum tight), neglect, or abuse, including burn holes from smoking or from the effluent of fireplaces, rips and tears caused by acts of nature, rodents and/or people, including animals walking on the cover or a tree limb falling on the cover. Damage, defects, malfunctions, or other failure caused by or related to repairs performed by any servicer other than an authorized service representative of SPQ Brands. Claims will not be accepted for a cover's damage in transit unless damage to shipping container is noted at time of delivery on the transport company's delivery bill.

SPQ BRANDS SHALL IN NO WAY BE LIABLE OR RESPONSIBLE UNDER ANY CIRCUMSTANCES OR IN ANY AMOUNT FOR ANY CONSEQUENTIAL OR INCIDENTAL DAMAGES OR FOR ANY INJURY OR DAMAGES TO PERSON OR PROPERTY USING OR USED IN CONNECTION WITH THIS PRODUCT, OR FOR LOSS OF PROFITS OR OTHER COSTS OR EXPENSES OF ANY KIND OR CHARACTER. THERE ARE NO OTHER WARRANTIES OR REPRESENTATIONS, EITHER EXPRESS OR IMPLIED, WHETHER OF MERCHANTABILITY, FITNESS FOR A PARTICULAR PURPOSE, OR OTHER, MADE BY SPQ BRANDS, OTHER THAN THOSE SPECIFICALLY SET FORTH IN THIS WARRANTY. NO PERSON, FIRM, OR CORPORATION IS AUTHORIZED TO MAKE ANY REPRESENTATIONS, OR INCUR ANY OBLIGATIONS IN THE NAME OF OR ON BEHALF OF SPQ BRANDS, EXCEPT AS STATED HEREIN. THIS WARRANTY IS EXPRESSLY UNDERSTOOD TO BE THE EXCLUSIVE REMEDY AVAILABLE TO THE PURCHASER, AND THIS WARRANTY CONTAINS THE FULL AND COMPLETE AGREEMENT BETWEEN SPQ BRANDS AND THE PURCHASER. THIS WARRANTY SETS FORTH THE ONLY OBLIGATIONS OF SPQ BRANDS WITH REGARD TO THIS PRODUCT, AND THERE ARE NO WARRANTIES WHICH EXTEND BEYOND THE DESCRIPTION ON THE FACE HEREOF.

To File a Claim:

Call 1-609-212-0221 between the hours of 8:30 am and 5:00 pm (Est)

The representations set forth herein are the only representations made by SPQ Brands with respect to the product, and this warranty does not constitute either a performance or satisfaction guarantee. It is the responsibility of the product owner to regularly test and check the product for proper function and safety.

This warranty gives the original purchaser specific legal rights. You may have other rights depending on where you live.